

Rusatom MetalTech LLC (the enterprise of Rosatom's Fuel Company TVEL, a divisional integrator in the Metallurgy area) localizes the production of permanent magnets of the neodymium-iron-boron system



RUSATOM  
METAL TECH  
ROSATOM

**400 t**

per year (wind energy)

**400 t**

per year (electric transport)

Installation and application  
in electric motors

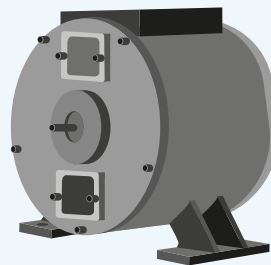

Installation in the wind  
generator rotor

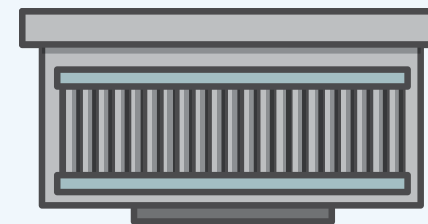

**Own production**

**1000 t per year**  
in 2027

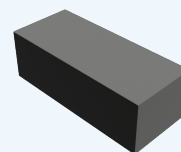

Permanent magnet

**3000 t per year**  
after 2030

**Key industries of application**

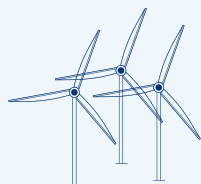

**Electrical power  
generation**

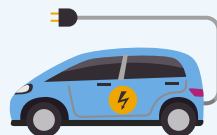

**Electric transportation**

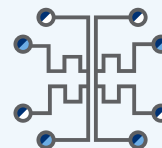

**Electronics**



**Aerospace industry**